

- MAIN WORSHIP
- NURSERIES
- CHILDREN'S MINISTRY
- STUDENT MINISTRY
- CLASSROOMS
- FAMILY LIFE CENTER
- KITCHEN
- M.** MEN'S RESTROOMS
- W.** WOMEN'S RESTROOMS
- P.** PRAYER ROOMS
- N.** NURSING ROOM

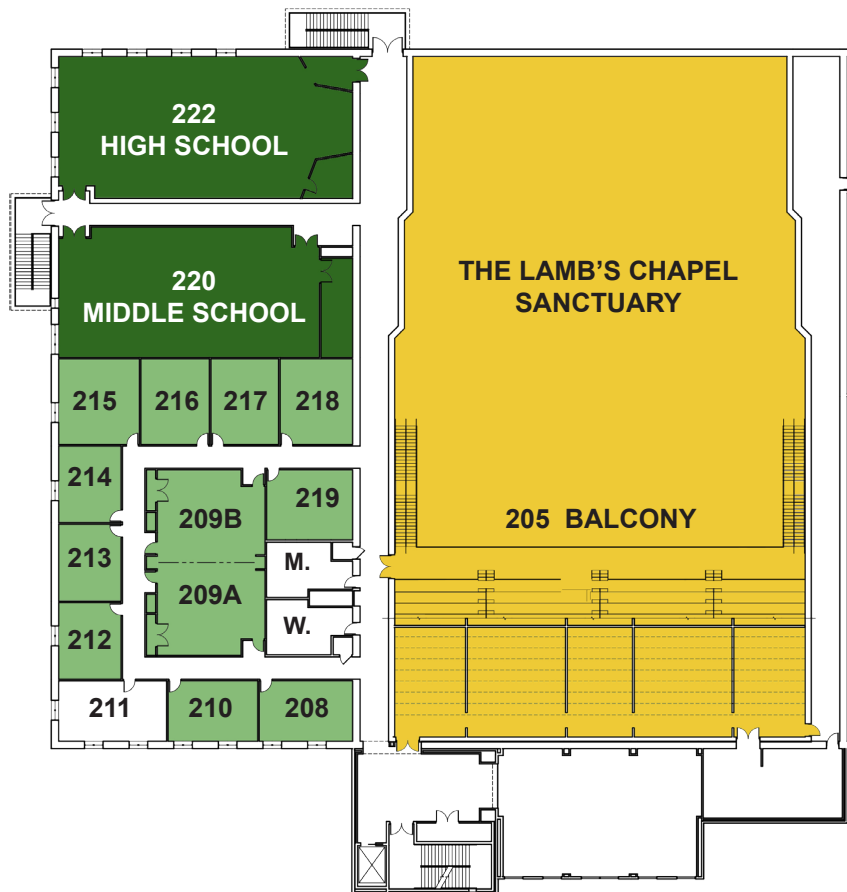

The Lamb's Chapel Map